

LEASEHOLD



Flat (EPC Rating: C)

**FLAT 6, GOODEARL COURT CONIFER RISE,
HIGH WYCOMBE, BUCKINGHAMSHIRE,**
Guide Price

£235,000

**Rye
View**
HOMES



2 Bedroom Flat located in High Wycombe

**** GUIDE PRICE OF £235,000 - £260,000 ****

RyeView Homes are pleased to present to the Sales market this well-presented two bedroom ground floor flat, situated within a quiet cul-de-sac to the South-West of High Wycombe.

The property comprises a generously sized open plan living/dining room, fitted kitchen, two bedrooms with en-suite to master and bathroom. Outside there are well maintained communal grounds with security entryphone system to communal hallway and allocated parking with further visitors bays available.

The accommodation in more detail comprises (all dimensions being approximate only):

Communal Entrance



Goodearl Court High Wycombe

Approximate Gross Internal Area = 56 sq m / 603 sq ft

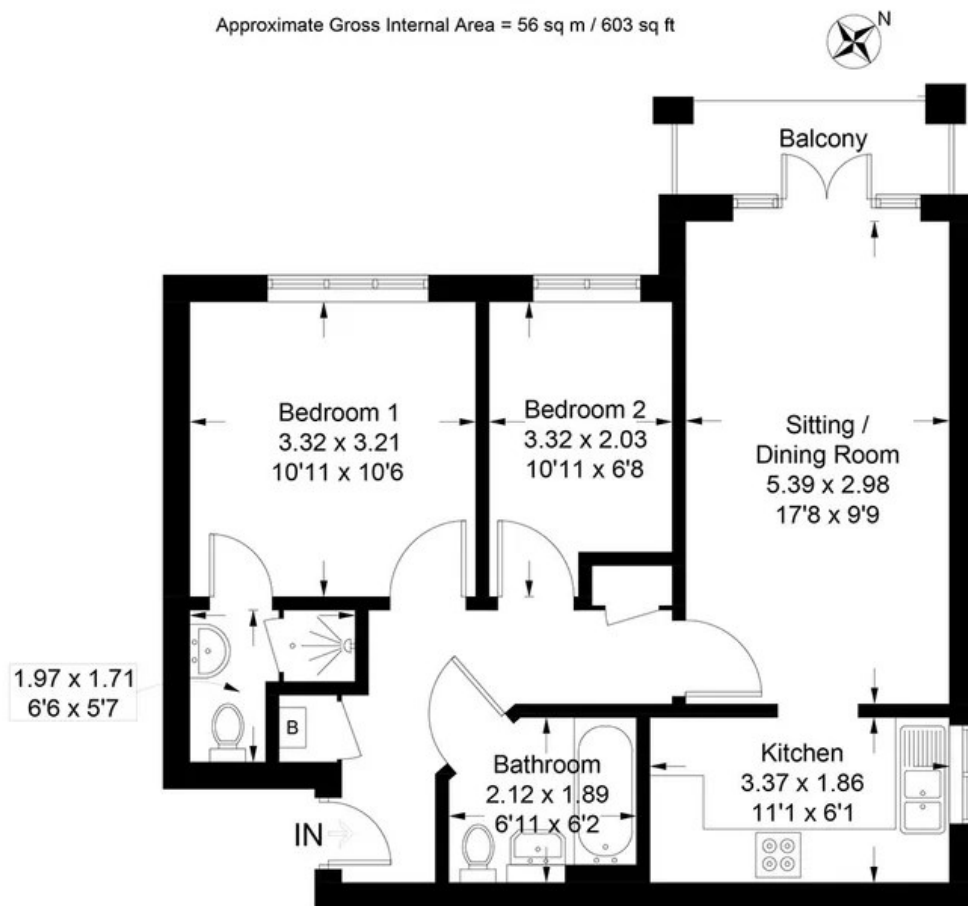

Ground Floor

Illustration for identification purposes only, measurements are approximate, not to scale.

COPYRIGHT RYEVIEWS HOMES

Council Tax Band

C

Energy Performance Graph

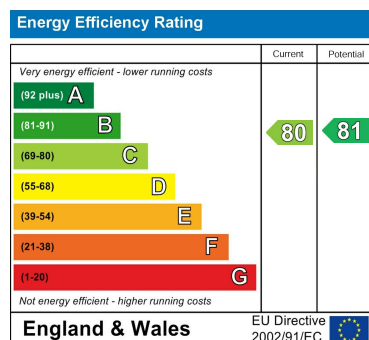

Call us on

01494 510099

info@ryevviewhomes.com

ryevviewhomes.com

Agents Note: Whilst every care has been taken to prepare these particulars, they are for guidance purposes only. All measurements are approximate and are for general guidance purposes only and whilst every care has been taken to ensure their accuracy, they should not be relied upon and potential buyers are advised to recheck the measurements.